

1

## Check the included items

As soon as you open the package, check to see that all items are included. If anything is missing, please contact your dealer.

- \* This package does not include a kick pedal, a hi-hat stand, and a snare stand. Use with a commercially available kick pedal, hi-hat stand, and snare stand.
- \* The drum key used to attach the pads is inside the packing carton of the bass drum.

## VAD307 parts

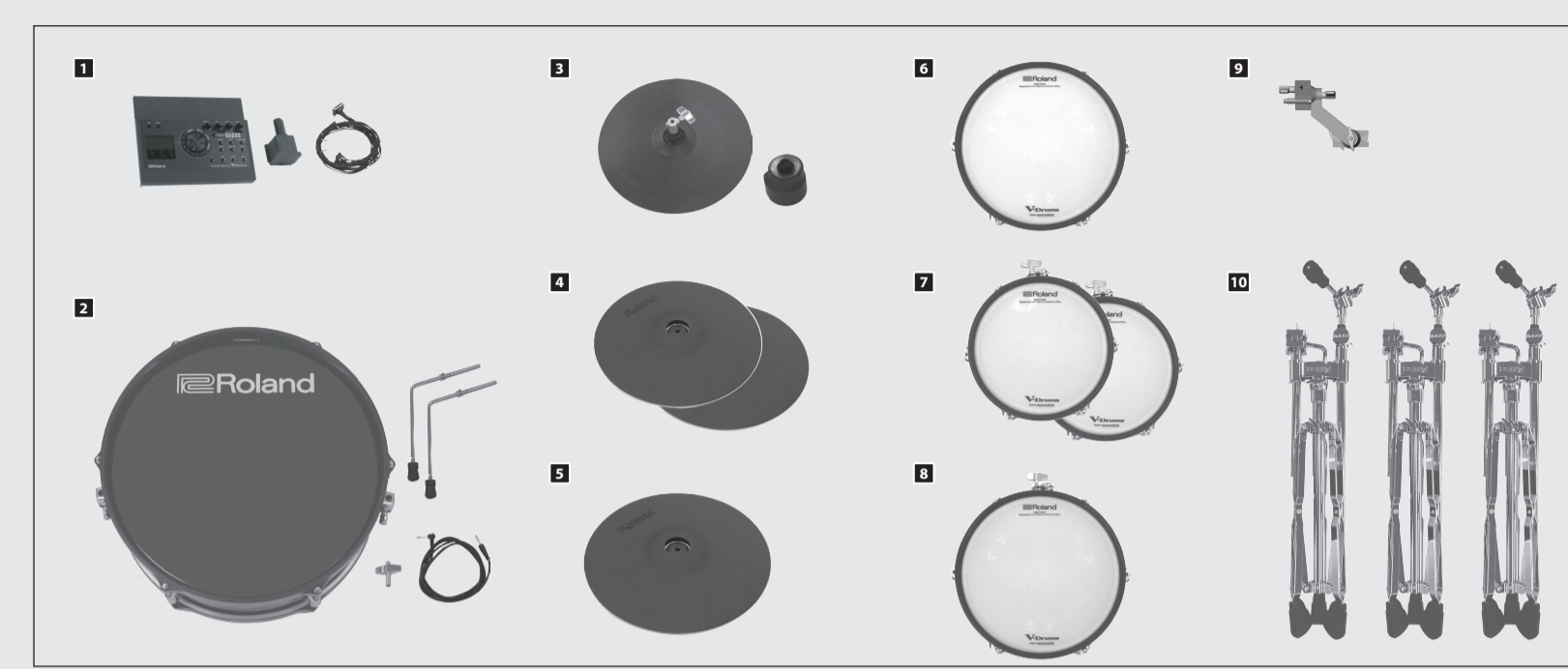

- |   |   |
|---|---|
| <ul style="list-style-type: none"> <li>1 TD-17 (Drum sound module) x 1</li> <li>Sound module mount x 1</li> <li>Dedicated connection cable x 1</li> <li>KD-180L (Bass drum) x 1</li> <li>Rod (with memory lock) x 2</li> <li>Trigger cable x 1 (for connecting Crash 2)</li> <li>Drum key x 1</li> <li>VH-10 (Hi-hat) x 1</li> <li>CY-12C-T (Crash 1, Crash 2) x 2</li> <li>CY-14R-T (Snare) x 1</li> <li>PDA120LS (Snare) x 1</li> <li>PDA100L (Tom 1, Tom 2) x 2</li> <li>PDA120L (Floor tom) x 1</li> <li>APC-30 (All purpose clamp) x 1</li> <li>DCS-30 (Drum combination stand) x 3</li> </ul> | <p><b>Owner's Manuals</b></p> <ul style="list-style-type: none"> <li><input type="checkbox"/> VAD307 Setup Guide (this document)</li> <li><input type="checkbox"/> TD-17 Owner's Manual</li> <li><input type="checkbox"/> KD-180L Owner's Manual</li> <li><input type="checkbox"/> CY-14R-T/CY-12C-T Owner's Manual</li> <li><input type="checkbox"/> VH-10 Owner's Manual</li> <li><input type="checkbox"/> DCS-30 Owner's Manual</li> <li><input type="checkbox"/> PDA120LS/PDA120L/PDA100L Owner's Manual</li> </ul> |
|---|---|

2

## Set Up the Stand

- \* The tips of the cymbal mount and tom holder are sharp. Handle them with care.
- \* When setting up or storing the stand, be careful not to pinch the fingers you use to handle the stand.

## Setup procedure

Set up the stand as shown in the illustration.

## Combination stand (DCS-30)

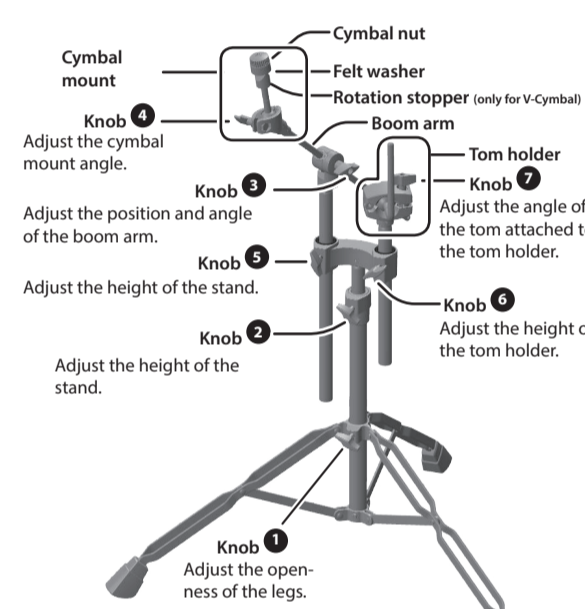

Attach the all-purpose clamp to the hi-hat stand (commercially available).

## Hi-hat stand

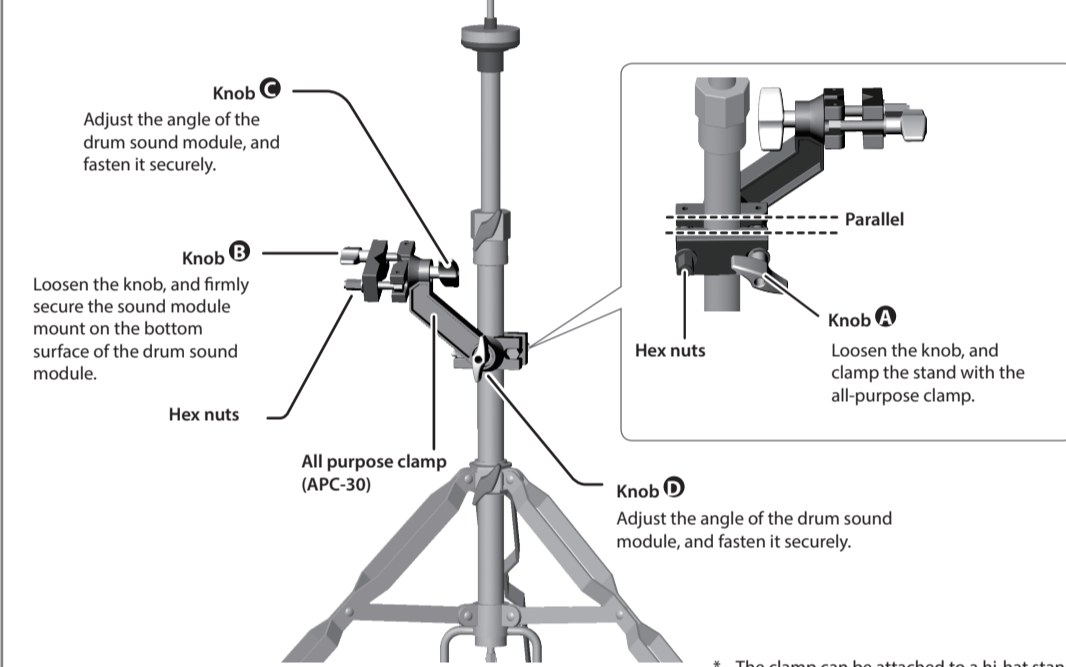

- \* The clamp can be attached to a hi-hat stand with a pipe diameter in the range of 15.9-28.6 mm (5/8"-1-1/8 inches).

## NOTE Stand

- When setting up, ensure that the tripod of the stand is sufficiently open. If the tripod is insufficiently open, the appropriate degree of stability might not be obtained.
- If you are using the boom arm in a lengthened position, stability will improve if the cymbal is directly above one of the tripod legs.
- Likewise, when attaching the tom to the tom holder, stability will improve if the tom is directly above one of the tripod legs.
- When you loosen the knob while adjusting the height or angle of tom or cymbal, the pipe or pad might fall and pinch your fingers. Use one hand to support the tom, pipe, or cymbal mount while you slowly loosen the knob.
- To prevent the stand from tipping over or falling, tighten the knobs until there is no looseness. When tightening knob ③ or knob ④, ensure that the gears that maintain the angle are firmly meshed.

## NOTE All purpose clamp

- Tighten the hex nut according to the diameter of the pipe that is being clamped. Ensure that the clamp is parallel with the main unit when the knob ① and knob ② is tightened.
- To prevent the stand from tipping over or falling, tighten the knobs until there is no looseness. When tightening knob ③ or knob ④, ensure that the gears that maintain the angle are firmly meshed.

3

## Attaching Various Parts

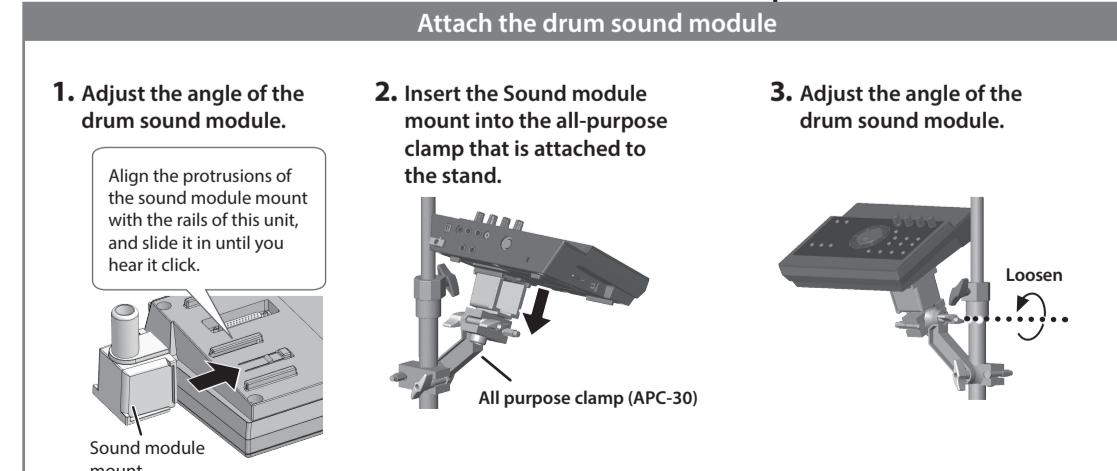
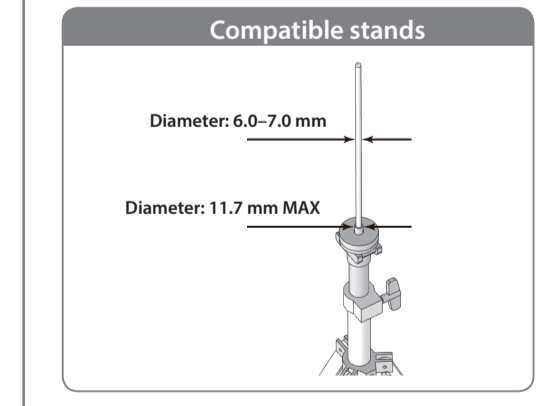
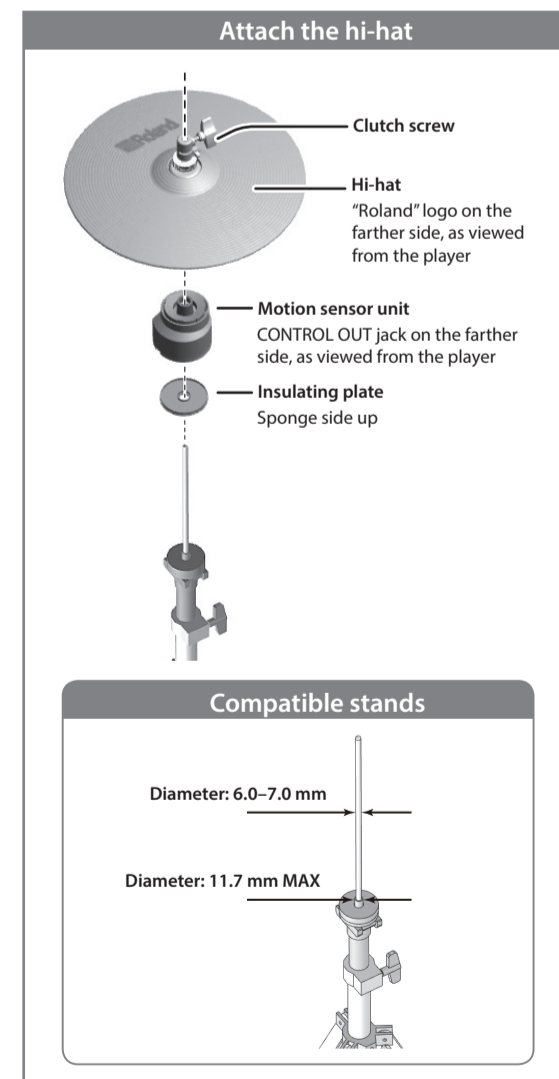

- Adjust the angle of the drum sound module.
- Insert the Sound module mount into the all-purpose clamp that is attached to the stand.
- Adjust the angle of the drum sound module.

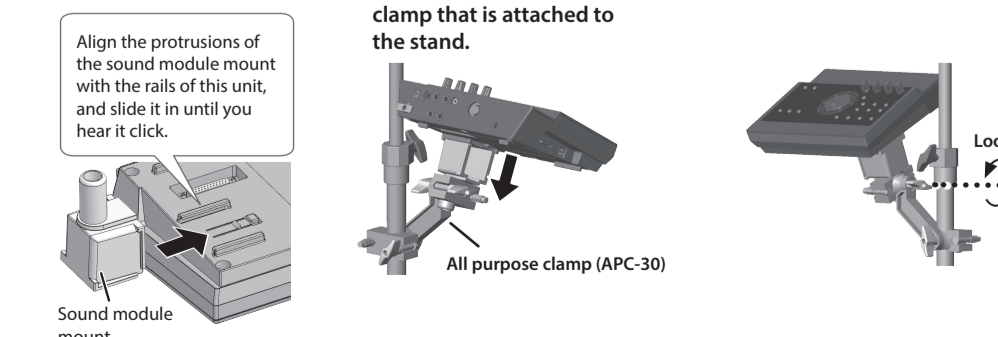

- The PDA120LS can only be used with a commercially available snare stand.
- \* Make sure that the snare stand you are using is able to support a 12-inch shell.

## Attach the crash cymbal and ride cymbal

- Position the cymbal so that the stopper (convex portion) of the cymbal mount is aligned with the concave portion of the bottom of the cymbal.
- Tighten the cymbal nut to obtain an appropriate amount of sway.

\* Use the cymbal nut and felt washer that are included with the drum stand.

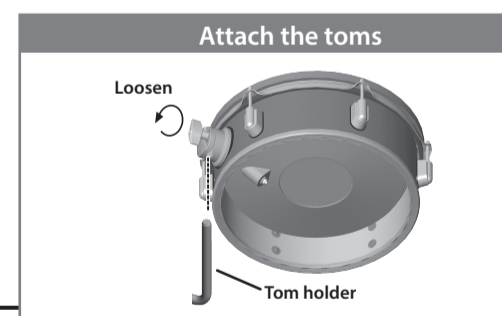

- Loosen the rod lock knob, and attach the rod.

## Attach the kick pedal

- Loosen the rod lock knob, and attach the rod.

- Attach the kick pedal at the kick pedal attachment position (the gap in the batter hoop).

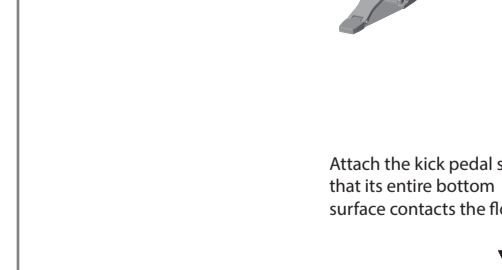

Attach the kick pedal so that its entire bottom surface contacts the floor.

**MEMO**  
For details on attaching the kick pedal, refer to the owner's manual of your kick pedal.

4

## Connect the pads to the drum sound module

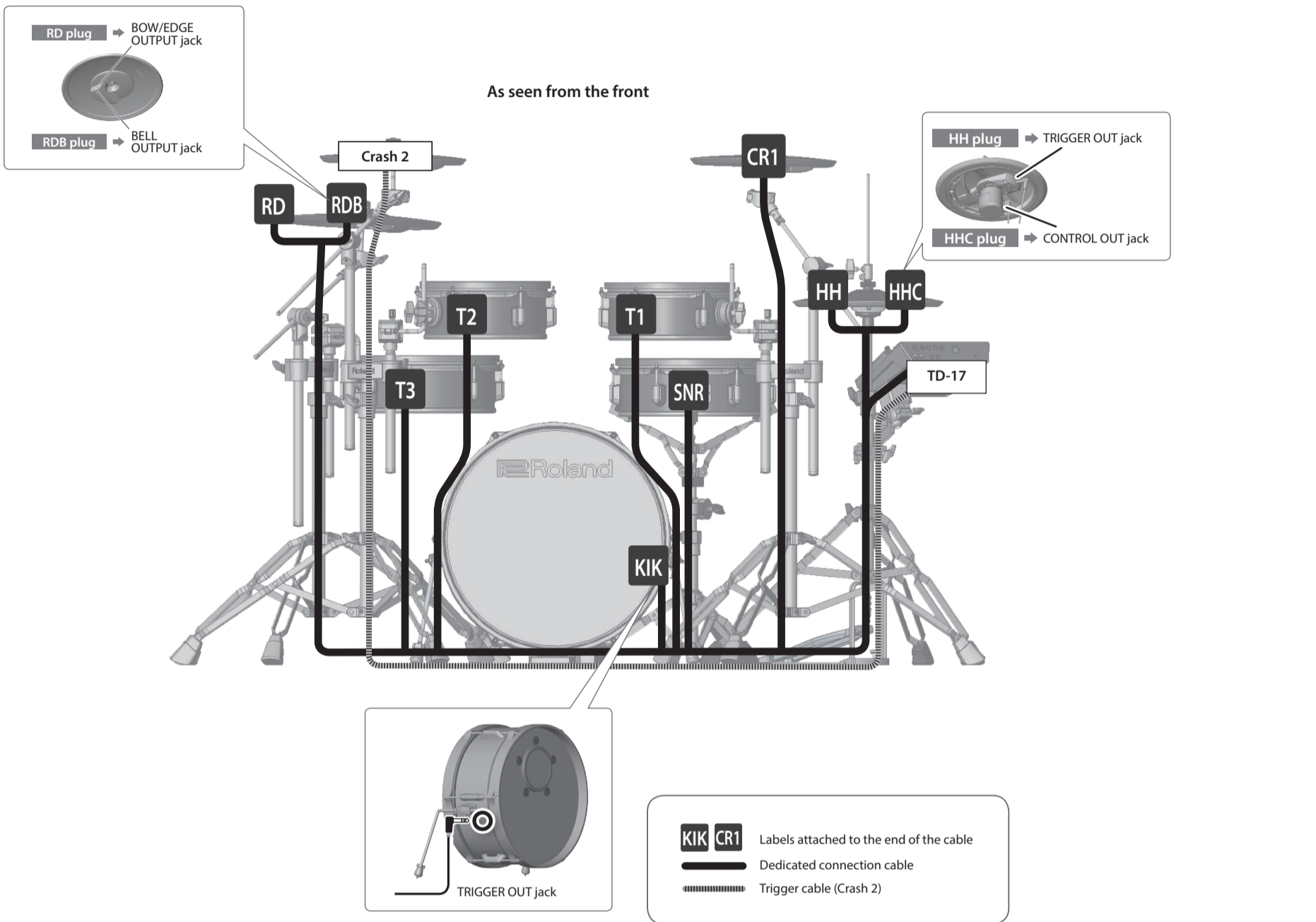
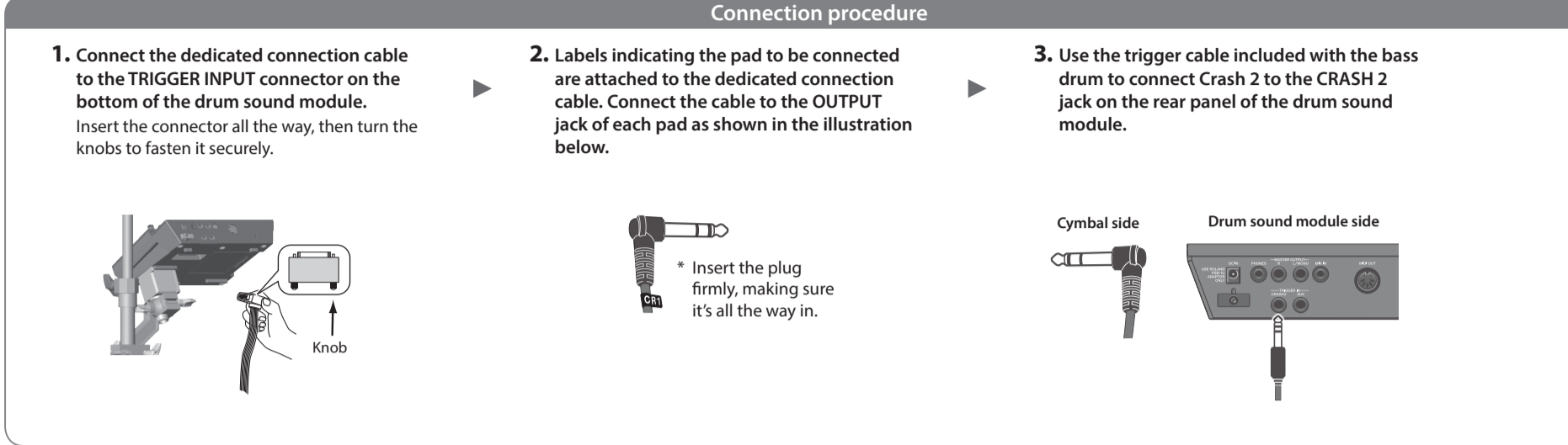

5

## Connect the AC adaptor and headphones

Connect the AC adaptor, headphones, or speakers.

- \* To prevent malfunction and equipment failure, always turn down the volume, and turn off all the units before making any connections.
- \* As shown in the illustration, use the cord hook to secure the cord of the AC adaptor.

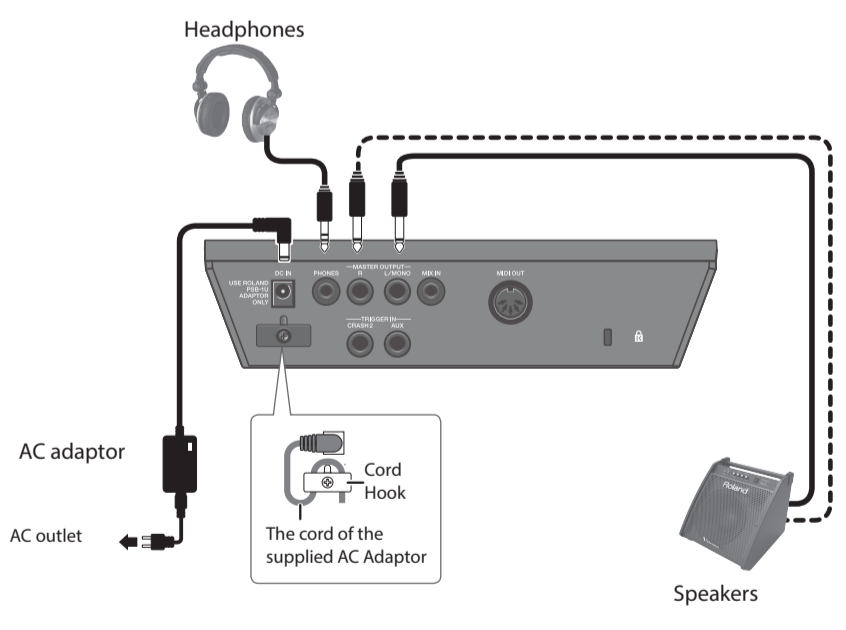

This completes setup and connections.

- When you've finished making connections, turn on the power as described in "TD-17 Owner's Manual", and verify that you can hear sound.



# Detailed explanation of each part

## Adjust the hi-hat (VH-10)

If you're using the VH-10-VH-hat, execute the offset adjustment from the drum sound module (TD-17) after making connections. This adjustment is required for pedal movements such as open or close to be detected correctly.

### 1 Adjust the offset.

1. With the hi-hat completely separated from the motion sensor unit, power-on the TD-17.

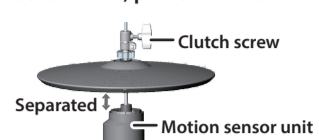

2. Loosen the clutch screw and let the hi-hat rest naturally on the motion sensor unit.
3. Press the [SETUP] button.
4. Use the dial to select the "Hi-Hat Settings", and press the [ENTER] button.
5. Use the dial to set the Pad Type to "VH10".

6. While reading the meter displayed on the right side of the TD-17's screen, adjust the offset with the VH-10's offset adjustment screw.

Adjust the offset so that the **OPEN** and **CLOSE** appear in the meter.

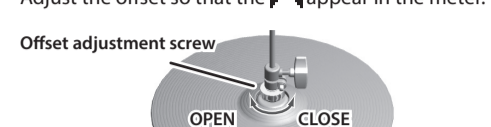

7. Fasten the clutch screw so that the hi-hat opens to the amount you prefer.
8. Press the [DRUM KIT] button to return to the KIT screen.

**NOTE**  
The hi-hat has a correct orientation. Positioning "Roland" logo on the farther side, as viewed from the player will operate correctly.



If you find the closed hi-hat sound difficult to play, turn the offset adjustment screw toward "CLOSE".  
If you find the open hi-hat sound difficult to play, turn it toward "OPEN".  
• If the sound is interrupted when you play a strong strike, adjust the offset adjustment screw toward "OPEN".

### Reference

For details on the hi-hat, refer to "VH-10 Owner's Manual".

### Fixing the cables

Wind the cable tie once  
Tighten it not to slip

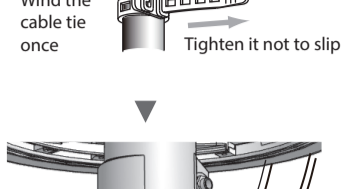

Leave some slack in the cables  
Turn back to fix the cables

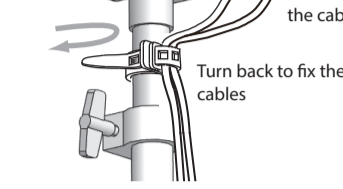

### NOTE

- Continuous playing may cause discoloration of the pad, but this will not affect the Pad's function.
- If the hi-hat clutch has been detached from the hi-hat, refer to "If the Clutch Was Apart from the Hi-Hat" in the "VH-10 Owner's Manual".

## Bass drum (KD-180L)

### 1 Attaching the rods

1. Loosen the rod lock knob, and attach the rod.

Position the rod so that the memory lock is in close contact with the bracket of the main unit, and then tighten the rod lock knob.

- \* We recommend that you use the memory lock in the factory-set position. This allows installation at the recommended rod length and angle.

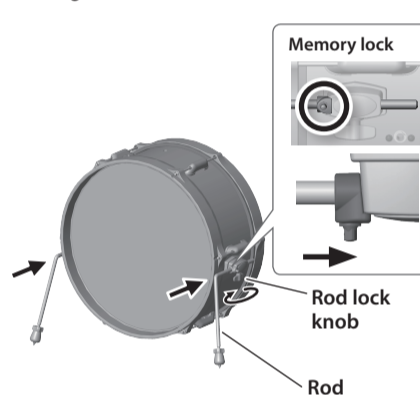

2. Adjust the tip of the rods (spike/rubber) appropriately for the location on which you're placing the bass drum.

Spike	Soft floor Carpet, etc.
Rubber	Hard floor Wood flooring, concrete, etc.

If you loosen the foot nut and rotate the foot to raise it, the spike will be exposed.  
Tighten the foot nut to secure the position of the foot.

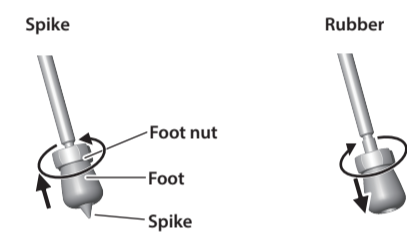

- \* The tip of the spike is sharp; handle it with care.
- \* Using the spike leg tips on wood flooring may damage the floor; the rubber leg tips should be used on wood flooring.

### 2 Attaching the kick pedal

1. Attach the kick pedal at the kick pedal attachment position (the gap in the batter hoop).

Adjust the location at which the kick pedal is attached so that the beater strikes the center of the batter head's strike surface; then securely fasten the kick pedal to the VAD307.

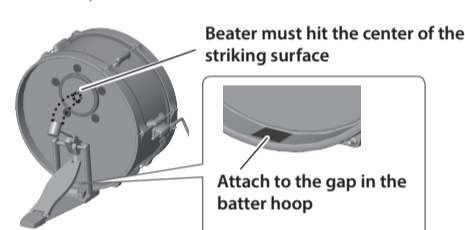

Attach the kick pedal so that its entire bottom surface contacts the floor.

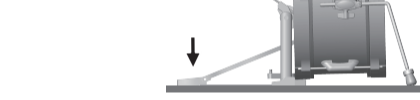

- \* A variety of commercially available beaters can be used, including felt, plastic, or wood types.  
However, if you use a felt beater, strike marks of the felt might remain on the striking surface.

### NOTE

- Secure the kick pedal and KD-180L firmly in place.
- Take care not to pinch your fingers.

### 3 Adjusting the head tension

Adjust the tension of the batter head before you play the bass drum. You can vary the strike response (playing feel) by adjusting the tension.

1. Adjust each tension bolt little by little, working back and forth across the head in the order shown in the illustration.

- \* Fully tightening a tension bolt at only a single location will produce uneven tensioning, which will make it impossible to achieve correct strike response and may also cause malfunctions.

2. Adjust each tension bolt so that the head is tensioned evenly.

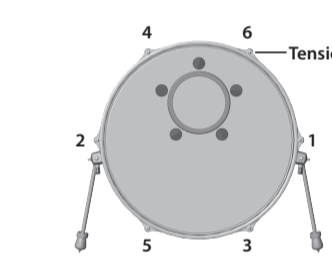

### NOTE

Adjusting the head tension affects only the head response, and does not change the pitch of the sound as it would on an acoustic drum.  
Pitch adjustments are made by editing the sound in your drum sound module.

### Reference

For details on the Bass Drum, refer to "KD-180L Owner's Manual".

## Snare (PDA120LS)

## Tom (PDA120L / PDA100L)

### Adjusting the head tension

1. Adjust each tuning bolt little by little, across the head as indicated in the illustration.

Slightly stronger tension than the strike feel of an acoustic drum is appropriate.

2. Make additional fine adjustments to the tension while you continue checking the feel of the pad's strike.

- \* Fully tightening a tension bolt at only a single location will produce uneven tensioning, which will make it impossible to achieve correct strike response and may also cause malfunctions.

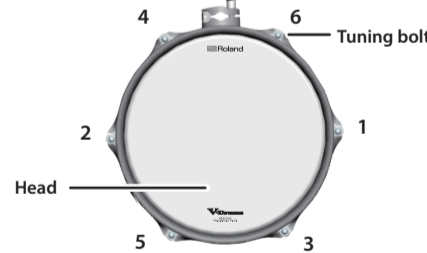

### NOTE

Adjusting the head tension affects only the head response, and does not change the pitch of the sound as it would on an acoustic drum.  
Pitch adjustments are made by editing the sound in your drum sound module.

### Reference

For details on the toms, refer to "PDA120LS/PDA120L/PDA100L Owner's Manual".

## Crash cymbal (CY-12C-T)

## Ride cymbal (CY-14R-T)

### Fixing the cables

Leave some slack in the cables



Be sure to make this small plastic hook visible from you.

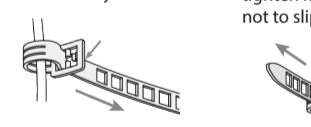

Wind a cable tie around a cable.  
Insert the small plastic hook to a hole to secure the cable to the cymbal arm.

Secure the cable in place with the cable tie

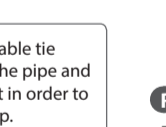

### Reference

For details on the cymbals, refer to "CY-14R-T/CY-12C-T Owner's Manual".

### NOTE

Continuous playing may cause discoloration of the pad, but this will not affect the Pad's function.

## USING THE UNIT SAFELY

### INSTRUCTIONS FOR THE PREVENTION OF FIRE, ELECTRIC SHOCK, OR INJURY TO PERSONS

#### About ⚠️ WARNING and ⚠️ CAUTION Notices

**⚠️ WARNING**  
Used for instructions intended to alert the user to the risk of death or severe injury should the unit be used improperly.

**⚠️ CAUTION**  
Used for instructions intended to alert the user to the risk of injury or material damage should the unit be used improperly.

#### About the Symbols

The ⚠️ symbol alerts the user to important instructions or warnings. The specific meaning of the symbol is determined by the design contained within the triangle. In the case of the symbol at left, it is used for general cautions, warnings or alerts to danger.

The ⚠️ symbol alerts the user to items that must never be carried out (see forbidden). The specific thing that must not be done is indicated by the design contained within the circle. In the case of the symbol at left, it means that the unit must never be disassembled.

The ⚠️ symbol alerts the user to things that must be carried out. The specific thing that must be done is indicated by the design contained within the circle. In the case of the symbol at left, it means that the power cord plug must be unplugged from the outlet.

### ALWAYS OBSERVE THE FOLLOWING

#### ⚠️ WARNING

Do not use or store in the following types of locations

- Subject to temperature extremes (e.g., direct sunlight in an enclosed vehicle, near a heating duct, on top of heat-generating equipment); or are
- Damp (e.g., baths, washrooms, on wet floors); or are
- Exposed to steam or smoke; or are
- Subject to salt exposure; or are
- Exposed to rain; or are
- Dusty or sandy; or are
- Subject to high levels of vibration and shock; or are
- Placed in a poorly ventilated location.

Use only the stand that is recommended

This unit should be used only with a stand that is recommended by Roland.

Do not place in a location that is unstable

When using the unit with a stand recommended by Roland, the stand must be carefully placed so it is level and sure to remain stable. If not using a stand, you still need to make sure that any location you choose for placing the unit provides a level surface that will properly support the unit, and keep it from wobbling.

#### ⚠️ CAUTION

Use only the specified stands!

This unit is designed to be used in combination with specific stands (DCS series) and all purpose clamp (APC-30) manufactured by Roland. If used in combination with other stands, you risk sustaining injuries as the result of this product dropping down or toppling over due to a lack of stability.

Evaluate safety issues before using stands

Even if you observe the cautions given in the owner's manual, certain types of handling may allow this product to fall from the stand, or cause the stand to overturn. Please be mindful of any safety issues before using this product.

Route all power cords and cables in such a way as to prevent them from getting entangled

Injury could result if someone were to trip on a cable and cause the unit to fall or topple.

Avoid climbing on top of the unit, or placing heavy objects on it

Damage or malfunction may result if you fail to disconnect all cables before moving the unit.

Take care so as not to get fingers pinched

When handling the following moving parts, take care so as not to get fingers, toes, etc., pinched. Whenever a child uses the unit, an adult should be on hand to provide supervision and guidance.

Included Parts:

- Cable tie
- Drum key

Removable Parts:

- Screws
- Washers
- Nuts
- Felt washers
- Springs
- Knobs
- Protective cap for dedicated connection cable

Keep small items out of the reach of children

To prevent accidental ingestion of the parts listed below, always keep them out of the reach of small children.

## IMPORTANT NOTES

### Additional Precautions

- Use a reasonable amount of care when using the unit's buttons, sliders, or other controls; and when using its jacks and connectors. Rough handling can lead to malfunctions.

- This instrument is designed to minimize the extraneous sounds produced when it's played. However, since sound vibrations can be transmitted through floors and walls to a greater degree than expected, take care not to allow these sounds to become a nuisance others nearby.

- When disposing of the packing carton or cushioning material in which this unit was packed, you must observe the waste disposal regulations that apply to your locality.

- This document explains the specifications of the product at the time that the document was issued. For the latest information, refer to the Roland website.

### Intellectual Property Right

- It is forbidden by law to make an audio recording, video recording, copy or revision of a third party's copyrighted work (musical work, video work, broadcast, live performance, or other work), whether in whole or in part, and distribute, sell, lease, perform, or broadcast it without the permission of the copyright owner.

- Do not use this product for purposes that could infringe on a copyright held by a third party. We assume no responsibility whatsoever with regard to any infringements of third-party copyrights arising through your use of this product.

- The copyright of content in this product (the sound waveform data, style data, accompaniment patterns, phrase data, audio loops and image data) is reserved by Roland Corporation.

- Purchasers of this product are permitted to utilize said content (except song data such as Demo Songs) for the creating, performing, recording and distributing original musical work.

- Purchasers of this product are NOT permitted to extract said content in original or modified form, for the purpose of distributing recorded medium of said content or making them available on a computer network.

- The SD logo and SDHC logo are trademarks of SD-3C, LLC.

- ASIO is a trademark and software of Steinberg Media Technologies GmbH.

- This product contains eParts integrated software platform of eSOL Co., Ltd. eParts is a trademark of eSOL Co., Ltd. in Japan.

- The Bluetooth® word mark and logos are registered trademarks owned by Bluetooth SIG, Inc. and any use of such marks by Roland is under license.

- This Product uses the Source Code of JF-Kernel under "L4 kernel 2.0" granted by the T-Engine Forum (www.tron.org).

- Roland is an either registered trademark or trademark of Roland Corporation in the United States and/or other countries.

- Company names and product names appearing in this document are registered trademarks or trademarks of their respective owners.

### For EU Countries

Manufacturer: Roland Corporation  
2036-1 Nakagawa, Hoso-cho, Kita-ku, Hamamatsu, Shizuoka 431-1304, JAPAN  
Importer: Roland Corporation  
ENA 23 Zone 1 nr. 1620 Klaus-Michael Kuehnlein 13, 2440 Geel, BELGIUM



### For the U.K.

Manufacturer: Roland Corporation  
2036-1 Nakagawa, Hoso-cho, Kita-ku, Hamamatsu, Shizuoka 431-1304, JAPAN  
Importer: Roland Europe Group Limited  
Hive 2, 1530 Arlington Business Park, Theale, Reading, Berkshire. RG7 4SA United Kingdom



### For EU Countries, For the U.K.



**UK** This symbol indicates that in EU countries, this product must be collected separately from household waste, as defined in each region. Products bearing this symbol must not be discarded together with household waste.

**DE** Dieses Symbol bedeutet, dass dieses Produkt in EU-Ländern getrennt vom Hausmüll gesammelt werden muss gemäß den regionalen Bestimmungen. Mit diesem Symbol gekennzeichnete Produkte dürfen nicht zusammen mit dem Hausmüll entsorgt werden.

**FR** Ce symbole indique que dans les pays de l'Union européenne, ce produit doit être collecté séparément des ordures ménagères selon les directives en vigueur dans chacune de ces pays. Les produits portant ce symbole ne doivent pas être mis au rebut avec les ordures ménagères.

**IT** Questo simbolo indica che nei paesi della Comunità europea questo prodotto deve essere smaltito separatamente dai normali rifiuti domestici, secondo la legislazione in vigore in ciascuna paese. I prodotti che riportano questo simbolo non devono essere smaltiti insieme ai rifiuti domestici. Ai sensi dell'art. 13 del D.Lgs. 25 luglio 2005 n. 151.

**ES** Este símbolo indica que en los países de la Unión Europea este producto debe recogerse aparte de los residuos domésticos, tal como está regulado en cada zona. Los productos con este símbolo no se deben depositar con los residuos domésticos.

**PT** Este símbolo indica que nos países da UE, a recolha deste produto deverá ser feita separadamente do lixo doméstico, de acordo com os regulamentos de cada região. Os produtos que apresentem este símbolo não deverão ser eliminados juntamente com o lixo doméstico.

**NL** Dit symbool geeft aan dat in landen van de EU dit product gescheiden van huishoudelijk afval moet worden aangeboden, zoals bepaald per gemeente of regio. Producten die van dit symbool zijn voorzien, mogen niet samen met huishoudelijk afval worden verwijderd.

**DK** Dette symbol angiver, at i EU-lande skal dette produkt opsamles adskilt fra husholdningsaffald, som defineret i hver enkelt region. Produkter med dette symbol må ikke smides ud sammen med husholdningsaffald.

**NO** Dette symbolet indikerer at produktet må behandles som spesialaffall i EU-land, det vil rettingsplikt for den enkelte region, og ikke kastes sammen med vanlig husholdningsaffall. Produkter som er merket med dette symbolet, må ikke kastes sammen med vanlig husholdningsaffall.

**SE** Symbolet anger att i EU-länder måste den här produkten kastas separat från hushållsavfall, i enlighet med varje regions bestämmelser. Produkter med den här symbolen får inte kastas tillsammans med hushållsavfall.

**FI** Tämä merkinäily ilmaisee, että tuote on EU-maissa kerättävä erillään kotitalousjätteen kanssa ilmeisen vaivastason määrätysten mukaisesti. Tällä merkinnällä varustettuja tuotteita ei saa hävittää kotitalousjätteen mukana.

**HU** Ez a szimbólum azt jelenti, hogy az Európai Unióban ezt a terméket a hátraktási hulladékok elkülönítve, az adott régióban érvényes szabályozás szerint kell gyűjteni. Az ezzel a szimbómmal ellátott termékeket nem szabad a háztartási hulladékok közé dobt.

**PL** Symbol oznacza, że zgodnie z regulacjami w odpowiednim regionie, w krajach UE produkt nie należy wyrzucać z odpadami domowymi. Produkty oznaczone tym symbolem nie można utylizować razem z odpadami domowymi.

**CZ** Tento symbol udává, že v zemích EU musí být tento výrobek shromažďován odděleně od domácího odpadu, jak je určeno pro každý region. V případě neovět tento symbol se nesmí vyhozovat spolu s domácími odpady.

**SK** Tento symbol vyjadruje, že v krajinách EÚ sa musí byť tento produkt vykonaný oddelene od domáceho odpadu, podľa nariadení platných v konkrétnej krajine. Produkty s týmto symbolom sa nesmú vyhazovať spolu s domovým odpadom.

**EE** See sümbool näitab, et EL-i maades tuleb see toode olmpiirgipäri eraldi koguda, nii nagu on igas piirkonnas määratletud. Selle sümbooliga märgitud tooteid ei tohi ära viia ühist koostolpripäri.

**LT** Šis simbolis rodo, kad ES šalyse šis produktas turi būti surenkamas atskirai nuo buitinių atliekų, kaip nustatyta kiekviename regione. Šio simbolio paleidžiant produktai neturi būti šimunami kartu su buitiniems atliekams.

**LV** Šis simbols norāda, ka ES valstīs šis produkts jāievie atsevišķi no mājsaimniecības atkritumiem, kā noteikts katrā reģionā. Produktus ar šo simbolu nedrīkst iznest kopā ar mājsaimniecības atkritumiem.

**SI** Ta simbol označuje, da je treba proizvod v državih EU zbrati ločeno od gospodinjstvih odpadkov, tako kot je določeno v vsaki regiji. Proizvoda s tem znakom ni dovoljeno odlagati skupaj z gospodinjstskimi odpadki.

**GR** Το σήμαλο αυτό υποδηλώνει ότι στις χώρες της Ε.Ε. οι οικιακοί απόβιοι πρέπει να συλλέγονται χωριστά από το οικιακό απόβιο. Τα προϊόντα που φέρουν το οικιακό απόβιο, δεν πρέπει να απορριπώνονται μαζί με το οικιακό απόβιο.